

HTD 5M, HTD 8M, HTD 14M

Fekerman supply 5M, 8M, 14M timing pulleys

Pulleys bore type:

Stock bore / Finished bore type

Material selection:

Steel C45 / Aluminum

Surface treatment:

Black oxide, Zinc plating, Anodizing

Fekerman accept custom made pulleys as per the drawings and technology requirement.

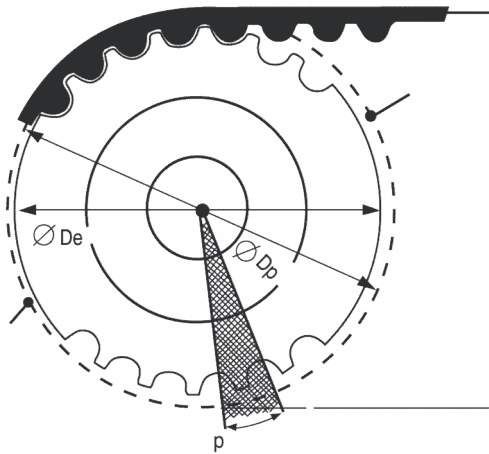

Pilot Bore Type

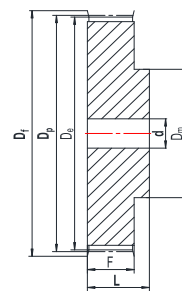

②F

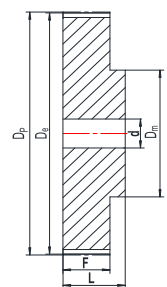

②

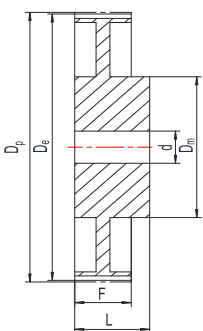

③

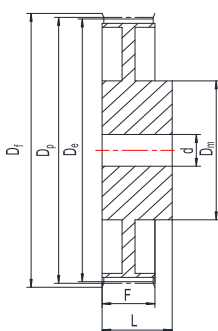

③F

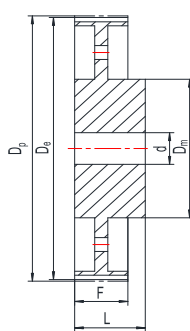

④

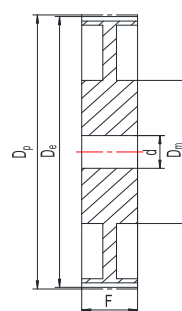

⑦

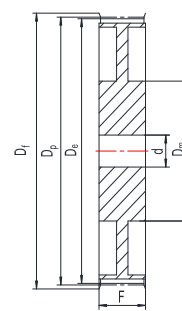

⑦F

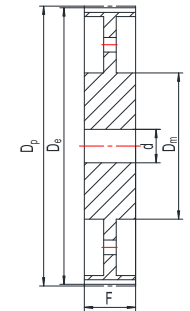

⑧

5M-09

For belt width 9mm

Part No.	Type	Mat.	Z	Dp	De	Df	Dm	F	L	d
12 5M-09	2F	St	12	19.10	17.96	23	12.5	14.5	20.0	6
14 5M-09	2F	St	14	22.28	21.14	25	13.5	14.5	20.0	6
15 5M-09	2F	St	15	23.87	22.73	28	15.5	14.5	20.0	6
16 5M-09	2F	St	16	25.46	24.32	28	16.5	14.5	20.0	6
18 5M-09	2F	St	18	28.65	27.51	32	20	14.5	20.0	6
20 5M-09	2F	St	20	31.83	30.69	36	23	14.5	22.5	6
21 5M-09	2F	St	21	33.42	32.28	38	24	14.5	22.5	6
22 5M-09	2F	St	22	35.01	33.87	38	25.5	14.5	22.5	6
24 5M-09	2F	St	24	38.20	37.06	42	27	14.5	22.5	6
26 5M-09	2F	St	26	41.38	40.24	44	30	14.5	22.5	6
28 5M-09	2F	St	28	44.56	43.42	48	30.5	14.5	22.5	6
30 5M-09	2F	St	30	47.75	46.60	51	35	14.5	22.5	6
32 5M-09	2F	St	32	50.93	49.79	54	38	14.5	22.5	8
36 5M-09	2F	St	36	57.30	56.16	60	38	14.5	22.5	8
40 5M-09	2F	St	40	63.66	62.52	71	38	14.5	22.5	8
44 5M-09	2	St	44	70.03	68.89	-	38	14.5	22.5	8
48 5M-09	2	St	48	76.39	75.25	-	45	14.5	22.5	8
60 5M-09	2	St	60	95.49	94.35	-	45	14.5	22.5	8
72 5M-09	2	St	72	114.59	113.45	-	45	14.5	22.5	8

5M-15

For belt width 15mm

Part No.	Type	Mat.	Z	Dp	De	Df	Dm	F	L	d
12 5M-15	2F	St	12	19.10	17.96	23	12.5	20.5	26	6
14 5M-15	2F	St	14	22.28	21.14	25	13.5	20.5	26	6
15 5M-15	2F	St	15	23.87	22.73	28	16	20.5	26	6
16 5M-15	2F	St	16	25.46	24.32	28	16.5	20.5	26	6
18 5M-15	2F	St	18	28.65	27.51	32	20	20.5	26	6
20 5M-15	2F	St	20	31.83	30.69	36	23	20.5	26	6
21 5M-15	2F	St	21	33.42	32.28	38	24	20.5	26	6
22 5M-15	2F	St	22	35.01	33.87	38	25.5	20.5	26	6
24 5M-15	2F	St	24	38.20	37.06	42	27	20.5	28	6
26 5M-15	2F	St	26	41.38	40.24	44	30	20.5	28	6
28 5M-15	2F	St	28	44.56	43.42	48	30.5	20.5	28	6
30 5M-15	2F	St	30	47.75	46.60	51	35	20.5	28	6
32 5M-15	2F	St	32	50.93	49.79	54	38	20.5	28	8
36 5M-15	2F	St	36	57.30	56.16	60	38	20.5	28	8
40 5M-15	2F	St	40	63.66	62.52	71	38	20.5	28	8
44 5M-15	2	St	44	70.03	68.89	-	38	20.5	30	8
48 5M-15	2	St	48	76.39	75.25	-	38	20.5	30	8
60 5M-15	2	St	60	95.49	94.35	-	50	20.5	30	8
72 5M-15	2	St	72	114.59	113.45	-	50	20.5	30	8

5M-25

For belt width 25mm

Part No.	Type	Mat.	Z	Dp	De	Df	Dm	F	L	d
12 5M-25	2F	St	12	19.10	17.96	23	12.5	30.5	36	6
14 5M-25	2F	St	14	22.28	21.14	25	13.5	30.5	36	6
15 5M-25	2F	St	15	23.87	22.73	28	16	30.5	36	6
16 5M-25	2F	St	16	25.46	24.32	28	16.5	30.5	36	6
18 5M-25	2F	St	18	28.65	27.51	32	20	30.5	36	6
20 5M-25	2F	St	20	31.83	30.69	36	23	30.5	36	6
21 5M-25	2F	St	21	33.42	32.28	38	24	30.5	38	6
22 5M-25	2F	St	22	35.01	33.87	38	25	30.5	38	6
24 5M-25	2F	St	24	38.20	37.06	42	27	30.5	38	6
26 5M-25	2F	St	26	41.38	40.24	44	30	30.5	38	6
28 5M-25	2F	St	28	44.56	43.42	48	30.5	30.5	38	6
30 5M-25	2F	St	30	47.75	46.60	51	35	30.5	38	6
32 5M-25	2F	St	32	50.93	49.79	54	38	30.5	38	8
36 5M-25	2F	St	36	57.30	56.16	60	38	30.5	38	8
40 5M-25	2F	St	40	63.66	62.52	71	38	30.5	38	8
44 5M-25	2	St	44	70.03	68.89	-	38	30.5	38	8
48 5M-25	2	St	48	76.39	75.25	-	38	30.5	38	8
60 5M-25	2	St	60	95.49	94.35	-	50	30.5	38	8
72 5M-25	2	St	72	114.59	113.45	-	50	30.5	38	8

8M-20

For belt width 20mm

Part No.	Type	Mat.	Z	Dp	De	Df	Dm	F	L	d
22 8M-20	2F	St	22	56.02	54.65	60	43	28	38	12
24 8M-20	2F	St	24	61.11	59.74	66	45	28	38	12
26 8M-20	2F	St	26	66.21	64.84	71	48	28	38	12
28 8M-20	2F	St	28	71.30	70.08	75	50	28	38	14
30 8M-20	2F	St	30	76.39	75.13	83	55	28	38	14
32 8M-20	2F	St	32	81.49	80.16	87	60	28	38	14
34 8M-20	2F	St	34	86.58	85.21	91	66	28	38	14
36 8M-20	2F	St	36	91.67	90.30	98	70	28	38	14
38 8M-20	2F	St	38	96.77	95.39	103	75	28	38	14
40 8M-20	2F	St	40	101.86	100.49	106	75	28	38	14
44 8M-20	2F	St	44	112.05	110.67	119	75	28	38	14
48 8M-20	2F	St	48	122.23	120.86	127	75	28	38	14
56 8M-20	3F	St	56	142.60	141.23	148	80	28	38	14
64 8M-20	3F	St	64	162.97	161.60	168	80	28	38	14
72 8M-20	3F	St	72	183.35	181.97	192	80	28	38	14
80 8M-20	3	St	80	203.72	202.35	-	90	28	38	14
90 8M-20	3	St	90	229.18	227.81	-	90	28	38	14
112 8M-20	4	St	112	285.21	283.83	-	90	28	38	18
144 8M-20	4	St	144	366.69	365.32	-	90	28	38	20
168 8M-20	4	St	168	427.81	426.44	-	100	28	38	20
192 8M-20	4	St	192	488.92	487.55	-	100	28	38	20

8M-30

For belt width 30mm

Part No.	Type	Mat.	Z	Dp	De	Df	Dm	F	L	d
22 8M-30	2F	St	22	56.02	54.65	60	43	38	48	12
24 8M-30	2F	St	24	61.11	59.74	66	45	38	48	12
26 8M-30	2F	St	26	66.21	64.84	71	48	38	48	12
28 8M-30	2F	St	28	71.30	70.08	75	50	38	48	14
30 8M-30	2F	St	30	76.39	75.13	83	55	38	48	14
32 8M-30	2F	St	32	81.49	80.16	87	60	38	48	14
34 8M-30	2F	St	34	86.58	85.21	91	66	38	48	14
36 8M-30	2F	St	36	91.67	90.30	98	70	38	48	14
38 8M-30	2F	St	38	96.77	95.39	103	75	38	48	14
40 8M-30	2F	St	40	101.86	100.49	106	75	38	48	14
44 8M-30	2F	St	44	112.05	110.67	119	75	38	48	14
48 8M-30	2F	St	48	122.23	120.86	127	75	38	48	14
56 8M-30	3F	St	56	142.60	141.23	148	90	38	48	14
64 8M-30	3F	St	64	162.97	161.60	168	90	38	48	14
72 8M-30	3F	St	72	183.35	181.97	192	95	38	48	14
80 8M-30	3	St	80	203.72	202.35	-	100	38	48	14
90 8M-30	3	St	90	229.18	227.81	-	100	38	48	14
112 8M-30	4	St	112	285.21	283.83	-	100	38	48	18
144 8M-30	4	St	144	366.69	365.32	-	100	38	48	20
168 8M-30	4	St	168	427.81	426.44	-	100	38	48	20
192 8M-30	4	St	192	488.92	487.55	-	100	38	48	20

8M-50

For belt width 50mm

Part No.	Type	Mat.	Z	Dp	De	Df	Dm	F	L	d
22 8M-50	2F	St	22	56.02	54.65	60	43	60	70	12
24 8M-50	2F	St	24	61.11	59.74	66	45	60	70	12
26 8M-50	2F	St	26	66.21	64.84	71	48	60	70	12
28 8M-50	2F	St	28	71.30	70.08	75	50	60	70	14
30 8M-50	2F	St	30	76.39	75.13	83	55	60	70	14
32 8M-50	2F	St	32	81.49	80.16	87	60	60	70	14
34 8M-50	2F	St	34	86.58	85.21	91	66	60	70	14
36 8M-50	2F	St	36	91.67	90.30	98	70	60	70	14
38 8M-50	2F	St	38	96.77	95.39	103	75	60	70	14
40 8M-50	2F	St	40	101.86	100.49	106	75	60	70	14
44 8M-50	2F	St	44	112.05	110.67	119	75	60	70	14
48 8M-50	2F	St	48	122.23	120.86	127	75	60	70	14
56 8M-50	7F	St	56	142.60	141.23	148	90	60	70	18
64 8M-50	7F	St	64	162.97	161.60	168	100	60	60	18
72 8M-50	7F	St	72	183.35	181.97	192	100	60	60	18
80 8M-50	7	St	80	203.72	202.35	-	110	60	60	18
90 8M-50	7	St	90	229.18	227.81	-	110	60	60	18
112 8M-50	8	St	112	285.21	283.83	-	110	60	60	18
144 8M-50	8	St	144	366.69	365.32	-	110	60	60	20
168 8M-50	8	St	168	427.81	426.44	-	120	60	60	20
192 8M-50	8	St	192	488.92	487.55	-	130	60	60	20

8M-85

For belt width 85mm

Part No.	Type	Mat.	Z	Dp	De	Df	Dm	F	L	d
22 8M-85	2F	St	22	56.02	54.65	60	43	95	105	12
24 8M-85	2F	St	24	61.11	59.74	66	45	95	105	12
26 8M-85	2F	St	26	66.21	64.84	71	48	95	105	12
28 8M-85	2F	St	28	71.30	70.08	75	50	95	105	14
30 8M-85	2F	St	30	76.39	75.13	83	55	95	105	14
32 8M-85	2F	St	32	81.49	80.16	87	60	95	105	14
34 8M-85	2F	St	34	86.58	85.21	91	66	95	105	14
36 8M-85	2F	St	36	91.67	90.30	98	70	95	105	14
38 8M-85	2F	St	38	96.77	95.39	103	75	95	105	14
40 8M-85	2F	St	40	101.86	100.49	106	75	95	105	14
44 8M-85	2F	St	44	112.05	110.67	119	75	95	105	14
48 8M-85	2F	St	48	122.23	120.86	127	75	95	105	14
56 8M-85	2F	St	56	142.60	141.23	148	80	95	105	18
64 8M-85	7F	St	64	162.97	161.60	168	100	95	95	18
72 8M-85	7F	St	72	183.35	181.97	192	110	95	95	18
80 8M-85	8	St	80	203.72	202.35	-	110	95	95	20
90 8M-85	8	St	90	229.18	227.81	-	110	95	95	20
112 8M-85	8	St	112	285.21	283.83	-	110	95	95	24
144 8M-85	8	St	144	366.69	365.32	-	120	95	95	24
168 8M-85	8	St	168	427.81	426.44	-	120	95	95	24
192 8M-85	8	St	192	488.92	487.55	-	130	95	95	24

14M-40

For belt width 40mm

Part No.	Type	Mat.	Z	Dp	De	Df	Dm	F	L	d
28 14M-40	2F	St	28	124.78	122.12	127	100	54	69	24
30 14M-40	2F	St	30	133.69	130.99	138	100	54	69	24
32 14M-40	2F	St	32	142.60	139.88	154	100	54	69	24
34 14M-40	2F	St	34	151.52	148.79	160	100	54	69	24
36 14M-40	2F	St	36	160.43	157.68	168	100	54	69	24
38 14M-40	2F	St	38	169.34	166.60	183	120	54	69	24
40 14M-40	2F	St	40	178.25	175.49	188	120	54	69	24
44 14M-40	2F	St	44	196.08	193.28	211	120	54	69	24
48 14M-40	3F	St	48	213.90	211.11	226	135	54	69	24
56 14M-40	3F	St	56	249.55	246.76	256	135	54	69	28
64 14M-40	3F	St	64	285.21	282.41	296	135	54	69	28
72 14M-40	4	St	72	320.86	318.06	-	135	54	69	28
80 14M-40	4	St	80	356.51	353.71	-	135	54	69	28
90 14M-40	4	St	90	401.07	398.28	-	135	54	69	28
112 14M-40	4	St	112	499.11	496.32	-	135	54	69	28
144 14M-40	4	St	144	641.71	638.92	-	135	54	69	28
168 14M-40	4	St	168	748.66	745.87	-	135	54	69	28
192 14M-40	4	St	192	855.62	852.82	-	135	54	69	28

14M-55

For belt width 55mm

Part No.	Type	Mat.	Z	Dp	De	Df	Dm	F	L	d
28 14M-55	2F	St	28	124.78	122.12	127	100	70	85	24
30 14M-55	2F	St	30	133.69	130.99	138	100	70	85	24
32 14M-55	2F	St	32	142.60	139.88	154	100	70	85	24
34 14M-55	2F	St	34	151.52	148.79	160	100	70	85	24
36 14M-55	2F	St	36	160.43	157.68	168	100	70	85	24
38 14M-55	2F	St	38	169.34	166.60	183	120	70	85	24
40 14M-55	2F	St	40	178.25	175.49	188	120	70	85	24
44 14M-55	2F	St	44	196.08	193.28	211	120	70	85	24
48 14M-55	7F	St	48	213.90	211.11	226	135	70	70	24
56 14M-55	7F	St	56	249.55	246.76	256	135	70	70	28
64 14M-55	7F	St	64	285.21	282.41	296	135	70	70	28
72 14M-55	8	GG	72	320.86	318.06	-	135	70	70	28
80 14M-55	8	GG	80	356.51	353.71	-	135	70	70	28
90 14M-55	8	GG	90	401.07	398.28	-	135	70	70	28
112 14M-55	8	GG	112	499.11	496.32	-	135	70	70	28
144 14M-55	8	GG	144	641.71	638.92	-	135	70	70	28
168 14M-55	8	GG	168	748.66	745.87	-	135	70	70	28
192 14M-55	8	GG	192	855.62	852.82	-	135	70	70	28

14M-85

For belt width 85mm

Part No.	Type	Mat.	Z	Dp	De	Df	Dm	F	L	d
28 14M-85	2F	St	28	124.78	122.12	127	100	102	117	24
30 14M-85	2F	St	30	133.69	130.99	138	100	102	117	24
32 14M-85	2F	St	32	142.60	139.88	154	100	102	117	24
34 14M-85	2F	St	34	151.52	148.79	160	100	102	117	24
36 14M-85	2F	St	36	160.43	157.68	168	100	102	117	32
38 14M-85	2F	St	38	169.34	166.60	183	120	102	117	32
40 14M-85	2F	St	40	178.25	175.49	188	135	102	117	32
44 14M-85	2F	St	44	196.08	193.28	211	135	102	117	32
48 14M-85	2F	St	48	213.90	211.11	226	135	102	117	32
56 14M-85	7F	St	56	249.55	246.76	256	150	102	102	32
64 14M-85	7F	St	64	285.21	282.41	296	150	102	102	32
72 14M-85	8	GG	72	320.86	318.06	-	150	102	102	32
80 14M-85	8	GG	80	356.51	353.71	-	150	102	102	32
90 14M-85	8	GG	90	401.07	398.28	-	150	102	102	32
112 14M-85	8	GG	112	499.11	496.32	-	150	102	102	32
144 14M-85	8	GG	144	641.71	638.92	-	150	102	102	32
168 14M-85	8	GG	168	748.66	745.87	-	150	102	102	32
192 14M-85	8	GG	192	855.62	852.82	-	165	102	102	32

14M-115

For belt width 115mm

Part No.	Type	Mat.	Z	Dp	De	Df	Dm	F	L	d
28 14M-115	2F	St	28	124.78	122.12	127	100	133	148	32
30 14M-115	2F	St	30	133.69	130.99	138	100	133	148	32
32 14M-115	2F	St	32	142.60	139.88	154	100	133	148	32
34 14M-115	2F	St	34	151.52	148.79	160	100	133	148	32
36 14M-115	2F	St	36	160.43	157.68	168	120	133	148	32
38 14M-115	2F	St	38	169.34	166.60	183	120	133	148	32
40 14M-115	2F	St	40	178.25	175.49	188	135	133	148	32
44 14M-115	2F	St	44	196.08	193.28	211	140	133	148	32
48 14M-115	2F	St	48	213.90	211.11	226	150	133	148	32
56 14M-115	2F	St	56	249.55	246.76	256	150	133	148	32
64 14M-115	7F	St	64	285.21	282.41	296	150	133	148	32
72 14M-115	8	GG	72	320.86	318.06	-	150	133	148	32
80 14M-115	8	GG	80	356.51	353.71	-	150	133	148	32
90 14M-115	8	GG	90	401.07	398.28	-	150	133	148	32
112 14M-115	8	GG	112	499.11	496.32	-	150	133	148	32
144 14M-115	8	GG	144	641.71	638.92	-	165	133	148	32
168 14M-115	8	GG	168	748.66	745.87	-	165	133	148	32
192 14M-115	8	GG	192	855.62	852.82	-	165	133	148	32

14M-170

For belt width 170mm

Part No.	Type	Mat.	Z	Dp	De	Df	Dm	F	L	d
28 14M-170	2F	St	28	124.78	122.12	127	100	187	202	32
30 14M-170	2F	St	30	133.69	130.99	138	100	187	202	32
32 14M-170	2F	St	32	142.60	139.88	154	100	187	202	32
34 14M-170	2F	St	34	151.52	148.79	160	100	187	202	32
36 14M-170	2F	St	36	160.43	157.68	168	120	187	202	32
38 14M-170	2F	St	38	169.34	166.60	183	135	187	202	32
40 14M-170	2F	St	40	178.25	175.49	188	140	187	202	32
44 14M-170	2F	St	44	196.08	193.28	211	160	187	202	32
48 14M-170	2F	St	48	213.90	211.11	226	160	187	202	32
56 14M-170	2F	St	56	249.55	246.76	256	160	187	202	32
64 14M-170	2F	St	64	285.21	282.41	296	180	187	202	32
72 14M-170	7	St	72	320.86	318.06	-	180	187	187	32
80 14M-170	7	St	80	356.51	353.71	-	180	187	187	32
90 14M-170	8	GG	90	401.07	398.28	-	180	187	187	38
112 14M-170	8	GG	112	499.11	496.32	-	200	187	187	38
144 14M-170	8	GG	144	641.71	638.92	-	220	187	187	38
168 14M-170	8	GG	168	748.66	745.87	-	220	187	187	38
192 14M-170	8	GG	192	855.62	852.82	-	220	187	187	38

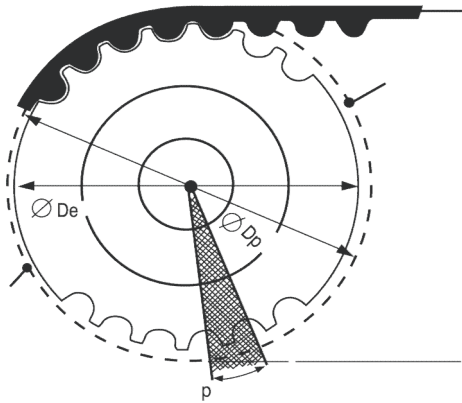

HTD 8M, HTD 14M

Fekerman supply 8M, 14M timing pulleys
Pulleys bore type: Taper bushed bore

Material:
Steel C45 / Aluminum
Surface treatment:
Black oxide, Anodizing, Chromium plating.

Fekerman accept custom made pulleys as per the drawings and technology requirement.

Taper Bushed Type

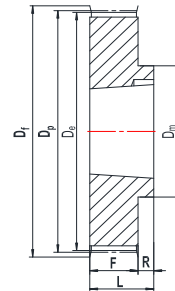

10F

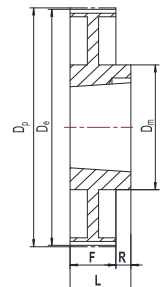

11

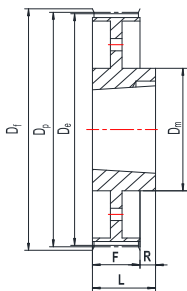

11F

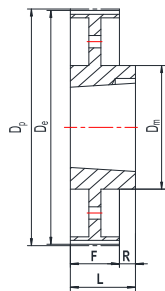

12

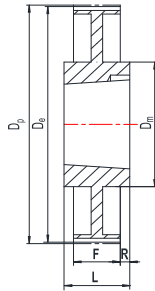

14

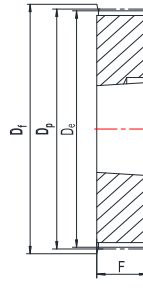

15F

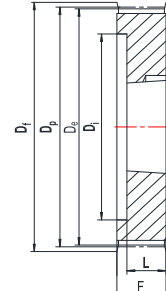

16F

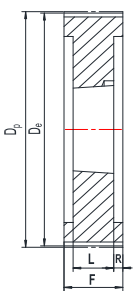

18

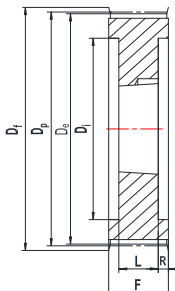

18F

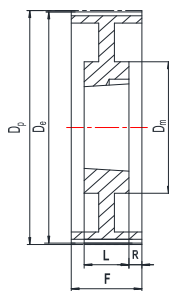

19

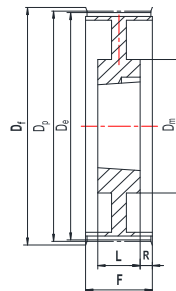

19F

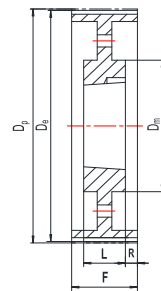

20

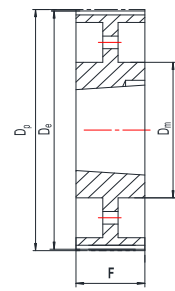

22

8M-20

for belt width 20mm

Pulleys with taper bushed bore

Part No.	Type	Bush	Z	Dp	De	Df	Dm	F	L	R
TB22 8M-20	16F	1008	22	56.02	54.65	60	–	28	22	6
TB24 8M-20	16F	1108	24	61.11	59.75	66	–	28	22	6
TB26 8M-20	16F	1108	26	66.21	64.84	71	–	28	22	6
TB28 8M-20	16F	1108	28	71.30	70.08	75	–	28	22	6
TB30 8M-20	16F	1108	30	76.39	75.13	83	–	28	22	6
TB32 80-20	16F	1610	32	81.49	80.16	87	–	28	25	3
TB34 8M-20	16F	1610	34	86.58	85.21	91	–	28	25	3
TB36 8M-20	16F	1610	36	91.67	90.30	98	–	28	25	3
TB38 8M-20	16F	1610	38	96.77	95.39	103	–	28	25	3
TB40 8M-20	16F	1610	40	101.86	100.49	106	–	28	25	3
TB44 8M-20	10F	2012	44	112.05	110.67	119	92	28	32	4
TB48 8M-20	10F	2012	48	122.23	120.86	127	96	28	32	4
TB56 8M-20	10F	2012	56	142.60	141.23	148	110	28	32	4
TB64 8M-20	11F	2012	64	162.97	161.60	168	110	28	32	4
TB72 8M-20	11F	2012	72	183.35	181.97	192	110	28	32	4
TB80 8M-20	11	2012	80	203.72	202.35	–	110	28	32	4
TB90 8M-20	11	2012	90	229.18	227.81	–	110	28	32	4

8M-30

for belt width 30mm

Pulleys with taper bushed bore

Part No.	Type	Bush	Z	Dp	De	Df	Dm	F	L	R
TB22 8M-30	16F	1008	22	56.02	54.65	60	–	38	22	16
TB24 8M-30	16F	1108	24	61.11	59.75	66	–	38	22	16
TB26 8M-30	16F	1108	26	66.21	64.84	71	–	38	22	16
TB28 8M-30	16F	1210	28	71.30	70.08	75	–	38	25	13
TB30 8M-30	15F	1615	30	76.39	75.13	83	–	38	38	–
TB32 80-30	15F	1615	32	81.49	80.16	87	–	38	38	–
TB34 8M-30	15F	1615	34	86.58	85.21	91	–	38	38	–
TB36 8M-30	15F	1615	36	91.67	90.30	98	–	38	38	–
TB38 8M-30	15F	1615	38	96.77	95.39	103	–	38	38	–
TB40 8M-30	15F	1615	40	101.86	100.49	106	–	38	38	–
TB44 8M-30	18F	2012	44	112.05	110.67	119	–	38	32	3
TB48 8M-30	18F	2012	48	122.23	120.86	127	–	38	32	3
TB56 8M-30	18F	2012	56	142.60	141.23	148	–	38	32	3
TB64 8M-30	10F	2517	64	162.97	161.60	168	125	38	45	7
TB72 8M-30	11F	2517	72	183.35	181.97	192	125	38	45	7
TB80 8M-30	11	2517	80	203.72	202.35	–	125	38	45	7
TB90 8M-30	11	2517	90	229.18	227.81	–	125	38	45	7
TB112 8M-30	12	2517	112	285.21	283.83	–	125	38	45	7
TB144 8M-30	12	2517	144	366.69	365.32	–	125	38	45	7

8M-50

for belt width 50mm

Pulleys with taper bushed bore

Part No.	Type	Bush	Z	Dp	De	Df	Dm	F	L	R
TB28 8M-50	16F	1210	28	71.30	70.08	75	–	60	25	35
TB30 8M-50	16F	1615	30	76.39	75.13	83	–	60	38	22
TB32 80-50	16F	1615	32	81.49	80.16	87	–	60	38	22
TB34 8M-50	16F	1615	34	86.58	85.21	91	–	60	38	22
TB36 8M-50	16F	1615	36	91.67	90.30	98	–	60	38	22
TB38 8M-50	16F	1615	38	96.77	95.39	103	–	60	38	22
TB40 8M-50	18F	2012	40	101.86	100.49	106	–	60	32	14
TB44 8M-50	18F	2012	44	112.05	110.67	119	–	60	32	14
TB48 8M-50	18F	2012	48	122.23	120.86	127	–	60	32	14
TB56 8M-50	18F	2517	56	142.60	141.23	148	–	60	45	7.5
TB64 8M-50	18F	2517	64	162.97	161.60	168	–	60	45	7.5
TB72 8M-50	19F	2517	72	183.35	181.97	192	125	60	45	7.5
TB80 8M-50	18	3020	80	203.72	202.35	–	–	60	51	4.5
TB90 8M-50	19	3020	90	229.18	227.81	–	160	60	51	4.5
TB112 8M-50	19	3020	112	285.21	283.83	–	170	60	51	4.5
TB144 8M-50	20	3020	144	366.69	365.32	–	170	60	51	4.5
TB168 8M-50	14	3525	168	427.81	426.44	–	198	60	65	2.5
TB192 8M-50	14	3525	192	488.92	487.55	–	198	60	65	2.5

8M-85

for belt width 85mm

Pulleys with taper bushed bore

Part No.	Type	Bush	Z	Dp	De	Df	Dm	F	L	R
TB34 8M-85	18F	1615	34	86.58	85.21	91	–	95	38	28.5
TB36 8M-85	18F	1615	36	91.67	90.30	98	–	95	38	28.5
TB38 8M-85	18F	1615	38	96.77	95.39	103	–	95	38	28.5
TB40 8M-85	18F	2012	40	101.86	100.49	106	–	95	32	31.5
TB44 8M-85	18F	2012	44	112.05	110.67	119	–	95	32	31.5
TB48 8M-85	18F	2517	48	122.23	120.86	127	–	95	45	25
TB56 8M-85	18F	2517	56	142.60	141.23	148	–	95	45	25
TB64 8M-85	18F	2517	64	162.97	161.60	168	–	95	45	25
TB72 8M-85	18F	3020	72	183.35	181.97	192	–	95	51	22
TB80 8M-85	18	3020	80	203.72	202.35	–	–	95	51	22
TB90 8M-85	19	3020	90	229.18	227.81	–	170	95	51	22
TB112 8M-85	19	3020	112	285.21	283.83	–	170	95	51	22
TB144 8M-85	20	3525	144	366.69	365.32	–	198	95	65	15
TB168 8M-85	20	3525	168	427.81	426.44	–	198	95	65	15
TB192 8M-85	20	3525	192	488.92	487.55	–	198	95	65	15

14M-40

for belt width 40mm

Pulleys with taper bushed bore

Part No.	Type	Bush	Z	Dp	De	Df	Dm	F	L	R
TB28 14M-40	18F	2012	28	124.78	122.12	127	–	54	32	11
TB30 14M-40	18F	2012	30	133.69	130.99	138	–	54	32	11
TB32 14M-40	18F	2012	32	142.60	139.88	154	–	54	32	11
TB34 14M-40	18F	2517	34	151.52	148.79	160	–	54	45	4.5
TB36 14M-40	18F	2517	36	160.43	157.68	168	–	54	45	4.5
TB38 14M-40	18F	2517	38	169.34	166.60	183	–	54	45	4.5
TB40 14M-40	18F	2517	40	178.25	175.49	188	–	54	45	4.5
TB44 14M-40	18F	3020	44	196.08	193.28	211	–	54	51	1.5
TB48 14M-40	18F	3020	48	213.90	211.11	226	–	54	51	1.5
TB56 14M-40	18F	3020	56	249.55	246.76	256	170	54	51	1.5
TB64 14M-40	19F	3020	64	285.21	282.41	296	170	54	51	1.5
TB72 14M-40	19	3020	72	320.86	318.06	–	170	54	51	1.5
TB80 14M-40	20	3020	80	356.51	353.71	–	170	54	51	1.5
TB90 14M-40	20	3020	90	401.07	398.28	–	170	54	51	1.5
TB112 14M-40	20	3020	112	499.11	496.32	–	170	54	51	1.5
TB144 14M-40	20	3020	144	641.71	638.92	–	170	54	51	1.5
TB168 14M-40	20	3020	168	748.66	745.87	–	170	54	51	1.5
TB192 14M-40	20	3020	192	855.62	852.82	–	170	54	51	1.5

14M-55

for belt width 55mm

Pulleys with taper bushed bore

Part No.	Type	Bush	Z	Dp	De	Df	Dm	F	L	R
TB28 14M-55	18F	2012	28	124.78	122.12	127	–	70	32	19
TB30 14M-55	18F	2517	30	133.69	130.99	138	–	70	45	12.5
TB32 14M-55	18F	2517	32	142.60	139.88	154	–	70	45	12.5
TB34 14M-55	18F	2517	34	151.52	148.79	160	–	70	45	12.5
TB36 14M-55	18F	2517	36	160.43	157.68	168	–	70	45	12.5
TB38 14M-55	18F	2517	38	169.34	166.60	183	–	70	45	12.5
TB40 14M-55	18F	2517	40	178.25	175.49	188	–	70	45	12.5
TB44 14M-55	18F	3020	44	196.08	193.28	211	–	70	51	9.5
TB48 14M-55	18F	3020	48	213.90	211.11	226	–	70	51	9.5
TB56 14M-55	18F	3020	56	249.55	246.76	256	170	70	51	9.5
TB64 14M-55	19F	3020	64	285.21	282.41	296	170	70	51	9.5
TB72 14M-55	19	3020	72	320.86	318.06	–	170	70	51	9.5
TB80 14M-55	20	3020	80	356.51	353.71	–	170	70	51	9.5
TB90 14M-55	20	3020	90	401.07	398.28	–	170	70	51	9.5
TB112 14M-55	20	3020	112	499.11	496.32	–	170	70	51	9.5
TB144 14M-55	20	3020	144	641.71	638.92	–	170	70	51	9.5
TB168 14M-55	20	3020	168	748.66	745.87	–	170	70	51	9.5
TB192 14M-55	20	3020	192	855.62	852.82	–	170	70	51	9.5

14M-85

for belt width 85mm

Pulleys with taper bushed bore

Part No.	Type	Bush	Z	Dp	De	Df	Dm	F	L	R
TB28 14M-85	18F	2517	28	124.78	122.12	127	–	102	45	28.5
TB30 14M-85	18F	2517	30	133.69	130.99	138	–	102	45	28.5
TB32 14M-85	18F	2517	32	142.60	139.88	154	–	102	45	28.5
TB34 14M-85	18F	2517	34	151.52	148.79	160	–	102	45	28.5
TB36 14M-85	18F	3020	36	160.43	157.68	168	–	102	51	25.5
TB38 14M-85	18F	3020	38	169.34	166.60	183	–	102	51	25.5
TB40 14M-85	18F	3020	40	178.25	175.49	188	–	102	51	25.5
TB44 14M-85	18F	3020	44	196.08	193.28	211	–	102	76	13
TB48 14M-85	18F	3020	48	213.90	211.11	226	–	102	76	13
TB56 14M-85	18F	3525	56	249.55	246.76	256	190	102	65	18.5
TB64 14M-85	19F	3525	64	285.21	282.41	296	190	102	65	18.5
TB72 14M-85	19	3525	72	320.86	318.06	–	190	102	65	18.5
TB80 14M-85	20	3525	80	356.51	353.71	–	190	102	65	18.5
TB90 14M-85	20	3525	90	401.07	398.28	–	190	102	65	18.5
TB112 14M-85	20	3525	112	499.11	496.32	–	190	102	65	18.5
TB144 14M-85	20	3525	144	641.71	638.92	–	190	102	65	18.5
TB168 14M-85	20	3525	168	748.66	745.87	–	190	102	65	18.5
TB192 14M-85	22	4040	192	855.62	852.82	–	230	102	102	–

14M-115

for belt width 115mm

Pulleys with taper bushed bore

Part No.	Type	Bush	Z	Dp	De	Df	Dm	F	L	R
TB28 14M-115	18F	2517	28	124.78	122.12	127	–	133	45	44
TB30 14M-115	18F	2517	30	133.69	130.99	138	–	133	45	44
TB32 14M-115	18F	2517	32	142.60	139.88	154	–	133	45	44
TB34 14M-115	18F	2517	34	151.52	148.79	160	–	133	45	44
TB36 14M-115	18F	3020	36	160.43	157.68	168	–	133	51	41
TB38 14M-115	18F	3020	38	169.34	166.60	183	–	133	51	41
TB40 14M-115	18F	3020	40	178.25	175.49	188	–	133	51	41
TB44 14M-115	18F	3020	44	196.08	193.28	211	–	133	76	28.5
TB48 14M-115	18F	3020	48	213.90	211.11	226	–	133	76	28.5
TB56 14M-115	18F	3535	56	249.55	246.76	256	190	133	89	22
TB64 14M-115	19F	3535	64	285.21	282.41	296	190	133	89	22
TB72 14M-115	19	3535	72	320.86	318.06	–	190	133	89	22
TB80 14M-115	20	3535	80	356.51	353.71	–	190	133	89	22
TB90 14M-115	20	3535	90	401.07	398.28	–	190	133	89	22
TB112 14M-115	20	3535	112	499.11	496.32	–	190	133	89	22
TB144 14M-115	20	4040	144	641.71	638.92	–	230	133	102	15.5
TB168 14M-115	20	4040	168	748.66	745.87	–	230	133	102	15.5
TB192 14M-115	20	4040	192	855.62	852.82	–	230	133	102	15.5