

## Index

06B	Page 2
08B	Page 3
10B	Page 4
12B	Page 5
16B	Page 6
20B	Page 7

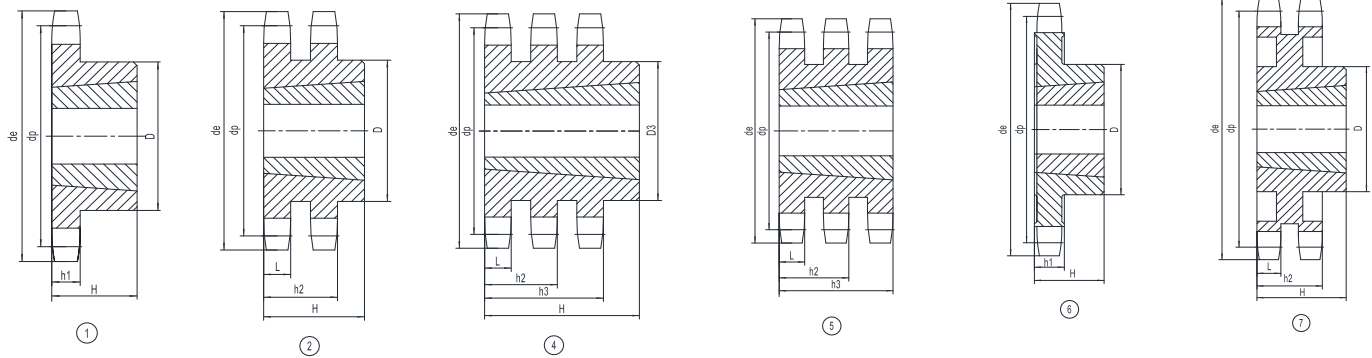



## 3/8" x 7/32"

06B - 1-2-3 9.525 x 5.72 mm DIN 8187 - ISO/R606

CHAIN	mm
Pitch	9.525
Internal width	5.72
Roller $\varnothing$	6.35

SPROCKETS	mm
Tooth radius r	10
Radius width C	1
Tooth width h1	5.3
Tooth width L	5.2
Tooth width h2	15.4
Tooth width h3	25.6

Material: Steel C45, \* Cast iron GG25

Z	de	dp	TS				TD				TT			
			D	H	for Bush	Type	D	H	for Bush	Type	D	H	for Bush	Type
17	55.3	51.83	45	22	1008	1	41	22	1008	2	—	25.6	1008	5
18	58.3	54.85	45	22	1008	1	43	22	1008	2				
19	61.3	57.87	45	22	1008	1	46	22	1008	2	—	25.6	1008	5
20	64.3	60.89	46	22	1008	1	48	22	1008	2				
21	68.0	63.91	46	22	1008	1	49	22	1008	2	—	25.6	1008	5
22	71.0	66.93	50	22	1108	1	52	22	1108	2				
23	73.5	69.95	63	25	1210	1	59	25	1210	2	—	25.6	1210	5
24	77.0	72.97	63	25	1210	1	61	25	1210	2				
25	80.0	76.02	63	25	1210	1	64	25	1210	2	—	25.6	1210	5
26	83.0	79.02	63	25	1210	1	65	25	1210	2				
27	86.0	82.02	63	25	1210	1	70	25	1210	2	—	25.6	1210	5
28	89.0	85.07	63	25	1210	1	70	25	1210	2				
30	94.7	91.12	63	25	1210	1	75	25	1210	2	79	38	1615	4
38	119.5	115.35	70	25	1210	1	80	25	1610	2	90	38	1615	4
45	140.7	136.55	70	25	1210	1	80	25	1610	2				
*57	176.9	172.91	70	25	1210	6	80	25	1610	7				
*76	234.9	230.49	70	25	1210	6	80	25	1610	7				
*95	292.5	288.08	80	25	1210	6	90	25	1610	7				
*114	349.5	345.68	80	38	1210	6	95	38	1615	7				

Options: Hardening teeth, surface treatment black oxide.

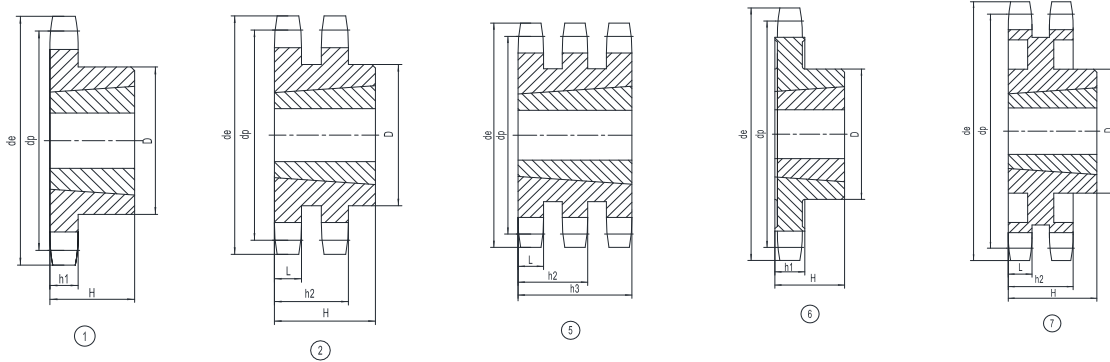

## 1/2" x 5/16"

08B - 1-2-3 12.7 x 7.75 mm DIN 8187 - ISO/R606

CHAIN	mm
Pitch	12.70
Internal width	7.75
Roller $\varnothing$	8.51

SPROCKETS	mm
Tooth radius r	13
Radius width C	1.3
Tooth width h1	7.2
Tooth width L	7
Tooth width h2	21
Tooth width h3	34.9

Material: Steel C45, \* Cast iron GG25

Z	de	dp	TS				TD				TT			
			D	H	for Bush	Type	D	H	for Bush	Type	D	H	for Bush	Type
15	65.5	61.90	45	22	1008	1	46	22	1008	2	—	34.9	1008	5
16	69.5	65.10	50	22	1108	1	50	22	1108	2				
17	73.6	69.11	60	25	1210	1	56	25	1210	2	—	34.9	1210	5
18	77.8	73.14	60	25	1210	1	60	25	1210	2				
19	81.7	77.16	63	25	1210	1	62	25	1210	2	—	34.9	1210	5
20	85.5	81.19	71	25	1610	1	66	25	1610	2				
21	89.7	85.22	71	25	1610	1	70	25	1610	2	—	34.9	1610	5
22	93.8	89.24	71	25	1610	1	76	25	1610	2				
23	98.2	93.27	76	25	1610	1	79	25	1610	2	—	34.9	1610	5
24	101.8	97.29	76	25	1610	1	84	25	1610	2				
25	105.8	101.33	76	25	1610	1	87	32	2012	2	—	34.9	2012	5
26	110.0	105.36	76	25	1610	1	87	32	2012	2				
27	114.4	109.40	76	25	1610	1	87	32	2012	2	—	34.9	2012	5
28	118.0	113.42	90	32	2012	1	87	32	2012	2				
30	126.1	121.50	90	32	2012	1	87	32	2012	2	—	34.9	2012	5
38	158.6	153.80	90	32	2012	1	100	32	2012	2	—	34.9	2012	5
45	188.0	182.07	100	32	2012	1	100	32	2012	2				
*57	236.4	230.54	100	32	2012	6	100	32	2012	7				
*76	313.3	307.33	100	32	2012	6	100	32	2012	7				
*95	390.1	384.11	100	32	2012	6	100	32	2012	7				
*114	466.9	460.90	110	45	2517	6	110	45	2517	7				

Options: Hardening teeth, surface treatment black oxide.

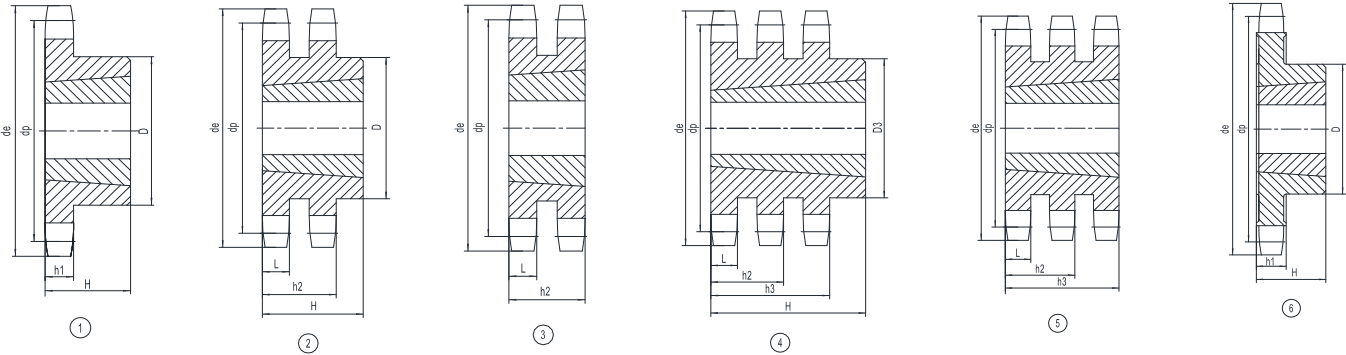

## 5/8" x 3/8"

10B - 1-2-3 15.875 x 9.65 mm DIN 8187 - ISO/R606

CHAIN	mm
Pitch	15.875
Internal width	9.65
Roller $\varnothing$	10.16

SPROCKETS	mm
Tooth radius r	16
Radius width C	1.6
Tooth width h1	9.1
Tooth width L	9
Tooth width h2	25.5
Tooth width h3	42.1

Material: Steel C45, \* Cast iron GG25

Z	de	dp	TS				TD				TT			
			D	H	for Bush	Type	D	H	for Bush	Type	D	H	for Bush	Type
13	73.0	66.32	47	22	1008	1	—	25.5	1210	3				
14	78.0	71.34	52	22	1108	1								
15	83.0	76.36	60	25	1210	1	—	25.5	1210	3	—	42.1	1210	5
16	88.0	81.37	70	25	1610	1								
17	93.0	86.36	71	25	1610	1	—	25.5	1610	3	—	42.1	1210	5
18	98.3	91.42	75	25	1610	1								
19	103.3	96.45	75	25	1610	1	—	25.5	1610	3	—	42.1	1615	5
20	108.4	101.49	75	25	1610	1	—	25.5	1610	3				
21	113.4	106.52	76	25	1610	1	—	25.5	1610	3	—	42.1	1615	5
22	118.0	111.55	76	25	1610	1	—	25.5	1610	3				
23	123.4	116.58	76	25	1610	1	—	25.5	1610	3	—	42.1	2012	5
24	128.3	121.62	90	32	2012	1								
25	134.0	126.66	90	32	2012	1	90	32.0	2012	2	110	45.0	2517	4
26	139.0	131.70	90	32	2012	1								
27	144.0	136.75	90	32	2012	1	90	32.0	2012	2	120	45.0	2517	4
28	148.7	141.78	90	32	2012	1								
30	158.8	151.87	90	32	2012	1	90	32.0	2012	2	120	45.0	2517	4
38	199.2	192.24	100	32	2012	1	108	45.0	2517	2				
45	235.0	227.58	100	32	2012	1								
*57	296.0	288.18	100	32	2012	6								
*76	392.1	384.16	100	32	2012	6								
*95	488.5	480.14	110	45	2517	6								
*114	584.1	576.13	110	45	2517	6								

Options: Hardening teeth, surface treatment black oxide.

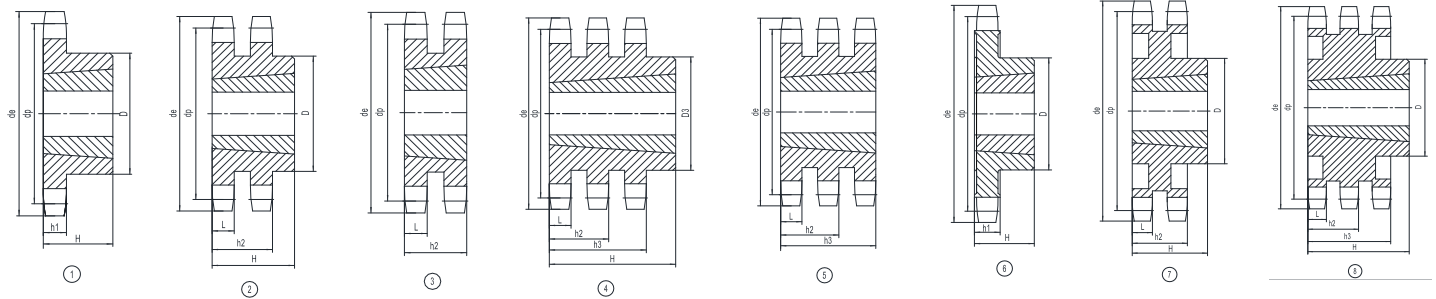

## 3/4" x 7/16"

12B - 1-2-3 19.05 x 11.68 mm DIN 8187 - ISO/R606

CHAIN	mm
Pitch	19.05
Internal width	11.68
Roller $\varnothing$	12.07

SPROCKETS	mm
Tooth radius r	19
Radius width C	2
Tooth width h1	11.1
Tooth width L	10.8
Tooth width h2	30.3
Tooth width h3	49.8

Material: Steel C45, \* Cast iron GG25

Z	de	dp	TS				TD				TT			
			d	H	for Bush	Type	d	H	for Bush	Type	d	H	for Bush	Type
13	87.5	79.59	60	25	1210	1								
14	93.6	85.61	70	25	1610	1								
15	99.8	91.63	70	25	1610	1	—	30.3	1610	3	—	49.8	1615	5
16	105.5	97.65	75	25	1610	1	—	30.3	1610	3				
17	111.5	103.67	76	25	1610	1	—	30.3	1610	3	—	49.8	2012	5
18	118.0	109.71	90	32	2012	1	90	32.0	2012	2				
19	124.2	115.75	90	32	2012	1	90	32.0	2012	2	—	49.8	2012	5
20	129.7	121.78	90	32	2012	1	108	45.0	2517	2				
21	136.0	127.82	102	45	2517	1	108	45.0	2517	2	—	49.8	2517	5
22	141.8	133.86	102	45	2517	1	108	45.0	2517	2				
23	149.0	139.90	108	45	2517	1	108	45.0	2517	2	—	49.8	2517	5
24	153.9	145.94	108	45	2517	1	108	45.0	2517	2				
25	160.0	152.00	108	45	2517	1	108	45.0	2517	2	—	49.8	2517	5
26	165.9	158.04	108	45	2517	1	108	45.0	2517	2				
27	172.3	164.00	108	45	2517	1	108	45.0	2517	2	140	51.0	3020	4
28	178.0	170.13	108	45	2517	1	108	45.0	2517	2				
30	190.5	182.25	108	45	2517	1	108	45.0	2517	2	140	51.0	3020	4
38	239.0	230.69	108	45	2517	1	140	51.0	3020	2	140	51.0	3020	4
45	282.5	273.10	108	45	2517	1	140	51.0	3020	2	140	51.0	3020	4
*57	355.4	345.81	108	45	2517	6	140	51.0	3020	7	140	51.0	3020	8
*76	469.9	460.99	108	45	2517	6	140	51.0	3020	7	140	51.0	3020	8
*95	585.1	576.17	108	45	2517	6	140	51.0	3020	7	140	76.0	3030	8
*114	700.6	691.36	108	64	2525	6	140	76.0	3030	7	140	76.0	3030	8

Options: Hardening teeth, surface treatment black oxide.

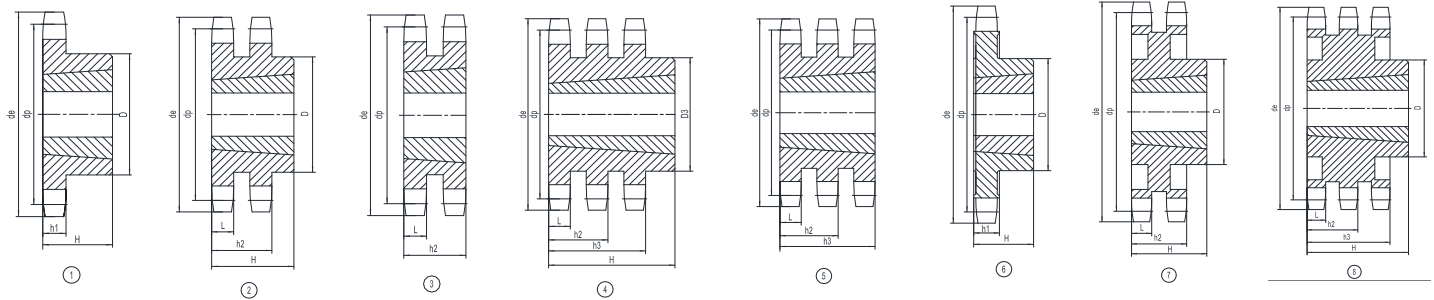

## 1" x 17.02 mm 16B - 1-2-3 25.4 x 17.2 mm DIN 8187 - ISO/R606

CHAIN	mm
Pitch	25.4
Internal width	17.02
Roller $\varnothing$	15.88

SPROCKETS	mm
Tooth radius r	26
Radius width C	2.5
Tooth width h1	16.2
Tooth width L	15.8
Tooth width h2	47.7
Tooth width h3	79.6

Material: Steel C45, \* Cast iron GG25

Z	de	dp	TS				TD				TT			
			d	H	for Bush	Type	d	H	for Bush	Type	d	H	for Bush	Type
13	117.0	106.12	73	25	1610	1	—	47.7	2012	3				
14	125.0	114.15	76	25	1610	1								
15	133.0	122.17	76	25	1610	1	—	47.7	2012	3				
16	141.0	130.20	90	32	2012	1								
17	149.0	138.22	90	32	2012	1	—	47.7	2517	3	—	79.6	2517	5
18	157.0	146.28	108	45	2517	1								
19	165.2	154.33	108	45	2517	1	—	47.7	2517	3	—	79.6	3020	5
20	173.2	162.38	108	45	2517	1								
21	181.2	170.43	110	45	2517	1	140	51	3020	2	—	79.6	3030	5
22	189.3	178.48	110	45	2517	1								
23	197.5	186.53	110	45	2517	1	140	51	3020	2	—	79.6	3525	5
24	205.5	194.59	110	45	2517	1								
25	213.5	202.66	110	45	2517	1	140	51	3020	2	—	79.6	3525	4
26	221.6	210.72	110	45	2517	1								
27	229.6	218.79	110	45	2517	1	140	51	3020	2	—	79.6	3525	4
28	237.7	226.85	110	45	2517	1								
30	254.0	243.00	140	51	3020	1	140	51	3020	2	—	79.6	3525	4
38	320.7	307.59	140	51	3020	1	140	51	3020	2	—	79.6	3525	4
45	377.1	364.13	140	51	3020	1	140	51	3020	2	215	102	4040	4
*57	474.0	461.07	140	51	3020	6	175	65	3525	7	215	102	4040	8
*76	627.0	614.65	140	51	3020	6	175	65	3525	7	215	102	4040	8
*95	781.1	768.22	140	51	3020	6	215	102	4040	7	215	102	4040	8
*114	934.3	921.81	140	76	3020	6	215	102	4040	7	260	114	4040	8

Options: Hardening teeth, surface treatment black oxide.

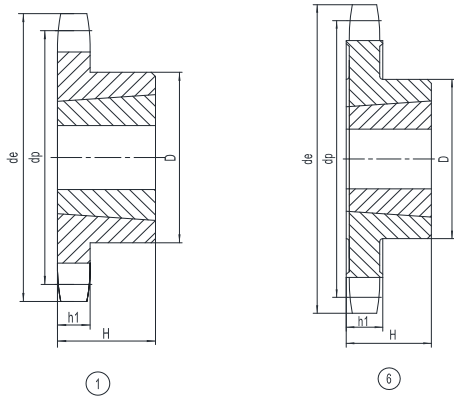

## 1.1/4" x 3/4"

20B - 1 31.75 x 19.56 mm DIN 8187 - ISO/R606

CHAIN	mm
Pitch	31.75
Internal width	19.56
Roller $\phi$	19.05

SPROCKETS	mm
Tooth radius r	32
Radius width C	3.5
Tooth width h1	18.5
Tooth width L	18.2
Tooth width h2	54.6
Tooth width h3	91

Material: Steel C45, \* Cast iron GG25

Z	de	dp	TS												
			d	H	for Bush	Type									
13	147.8	132.65	90	32	2012	1									
14	157.8	142.68	90	32	2012	1									
15	167.9	152.72	108	45	2517	1									
16	177.9	162.75	108	45	2517	1									
17	187.9	172.78	108	45	2517	1									
18	198.0	182.85	108	45	2517	1									
19	208.1	192.91	108	45	2517	1									
20	218.1	202.98	108	45	2517	1									
21	228.2	213.04	108	45	2517	1									
22	238.3	223.11	108	45	2517	1									
23	248.3	233.17	108	45	2517	1									
24	258.4	243.23	108	45	2517	1									
25	268.5	253.33	108	45	2517	1									
27	288.6	273.40	150	51	3020	1									
30	318.9	303.75	150	51	3020	1									
38	399.6	384.49	160	51	3020	1									
*45	470.3	455.17	160	51	3020	6									
*57	591.5	576.36	160	51	3020	6									
*76	783.5	768.32	160	51	3020	6									

Options: Hardening teeth, surface treatment black oxide.